

## MINIMILL

Nut- und Formzirkularfräsen

groove milling by circular interpolation

## Typ Z622 / Z622.X

Nutfräsen allgemein

groove milling general use

D min. 22 mm  
t max. = 4.5

D min. 22 mm  
t max. = 4.5

Z622 geradverzahnt / spur-toothed

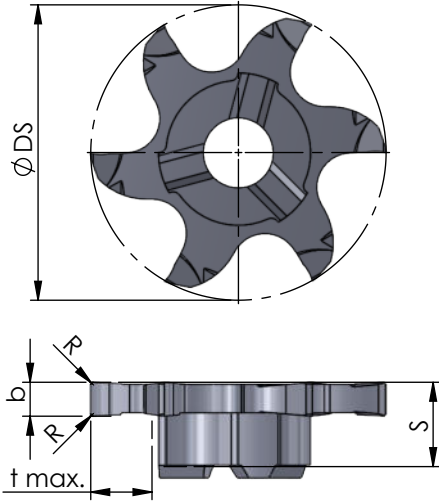

Z622.X kreuzverzahnt / staggered-toothed

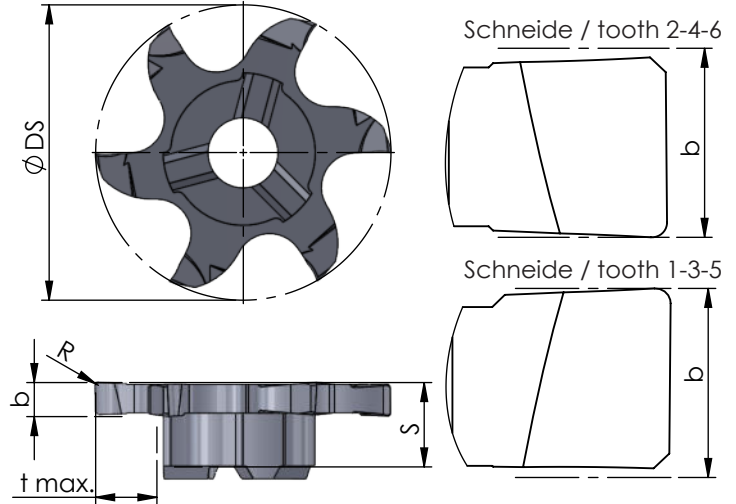

Abmessungen in mm

dimensions in mm

Bestellnummer part number	D min.	S	R	Ø DS	b +0.02	b (inch)	t max.	Zähnezahl number of teeth	K10F AL41F P18C	für Fräseschaft for milling shank
Z622.0100.01	22	5.8	0.1	21.7	1.0		4.5	6	●	ZH22...
Z622.0117.01	22	6.0	0.1	21.7	1.17	0.046"	4.5	6	●	
Z622.0150.01	22	6.2	0.1	21.7	1.5		4.5	6	●	
Z622.0157.01	22	6.2	0.1	21.7	1.57	0.062"	4.5	6	●	
Z622.0200.02	22	6.2	0.2	21.7	2.0		4.5	6	●	
Z622.X200.02	22	6.2	0.2	21.7	2.0		4.5	6	●	
Z622.0238.02	22	6.2	0.2	21.7	2.38	0.094"	4.5	6	●	
Z622.0250.02	22	6.2	0.2	21.7	2.5		4.5	6	●	
Z622.X250.02	22	6.2	0.2	21.7	2.5		4.5	6	●	
Z622.0300.02	22	6.2	0.2	21.7	3.0		4.5	6	●	
Z622.X300.02	22	6.2	0.2	21.7	3.0		4.5	6	●	
Z622.0318.02	22	5.5	0.2	21.7	3.18	0.125"	4.5	6	●	
Z622.0400.02	22	6.2	0.2	21.7	4.0		4.5	6	●	
Z622.X400.02	22	6.2	0.2	21.7	4.0		4.5	6	●	

Weitere HM Sorten können Sie in der Sortenübersicht im Kapitel "Technische Hinweise" und der Preisliste finden.

Bestellbeispiel:  
für Sorte AL41F:  
Z622.0100.01/AL41F

More carbide grades you can find in the grades summary in the chapter "technical instructions" and in the price list.

order-example:  
grade AL41F:  
Z622.0100.01/AL41F