

## ULTRAMINI

Bohrungsbearbeitung  
ab  $\varnothing$  0.2 mm

grooving, boring and profiling  
starting at  $\varnothing$  0.2 mm

## Performanceline Typ P07M

Stechdrehen  
mit Eckenradius  
und innerer Kühlmittelzufuhr

D min. 6.8 mm  
Stechtiefe t max. 2.5 mm

grooving  
with corner radius  
and through coolant

D min. 6.8 mm  
depth of groove t max. 2.5 mm

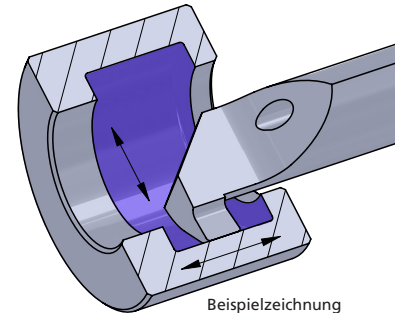
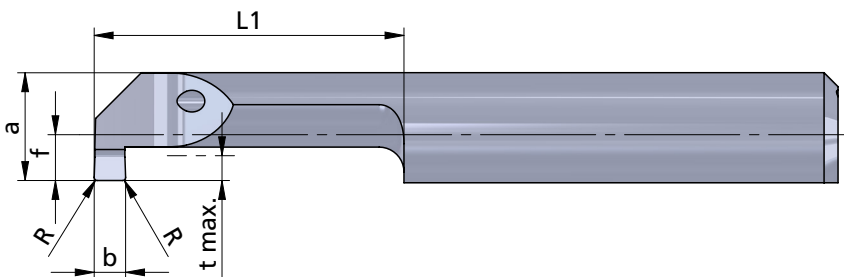
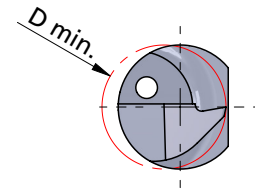
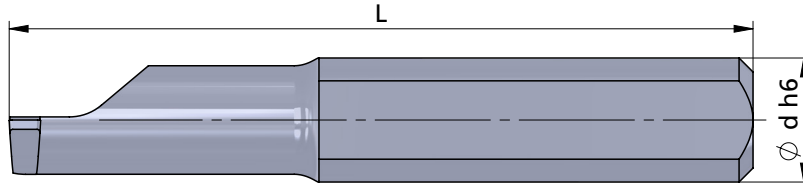

Beispielzeichnung  
exemplary application

Rechts (R): wie gezeichnet  
Links (L): spiegelbildlich

righthand (R): as shown  
lefthand version (L): mirror image

Abmessungen in mm

dimensions in mm

	Bestellnummer part number	b +0.05	b (inch)	R	f	a	L	L1	t max.	D min.	Ø d h6	Klemmhalter Typ				Klemmhalter Typ toolholder type
												K10F	P04C	AL41F	P07C	
neu	R/L P07M0100-10	1.0		0.1	2.8	6.3	25	10	2.5	6.8	7.0	●				
neu	R/L P07M0100-15	1.0		0.1	2.8	6.3	30	15	2.5	6.8	7.0	●				
neu	R/L P07M0100-22	1.0		0.1	2.8	6.3	37	22	2.5	6.8	7.0	●				
neu	R/L P07M0100-25	1.0		0.1	2.8	6.3	40	25	2.5	6.8	7.0	●				
neu	R/L P07M0100-30	1.0		0.1	2.8	6.3	45	30	2.5	6.8	7.0	●				
neu	R/L 007M0117-10	1.17	0.046"	0.1	2.8	6.3	25	10	2.5	6.8	7.0	●				
neu	R/L P07M0117-22	1.17	0.046"	0.1	2.8	6.3	37	22	2.5	6.8	7.0	●				
neu	R/L P07M0150-10	1.5		0.1	2.8	6.3	25	10	2.5	6.8	7.0	●				
neu	R/L P07M0150-15	1.5		0.1	2.8	6.3	30	15	2.5	6.8	7.0	●				
neu	R/L P07M0150-22	1.5		0.1	2.8	6.3	37	22	2.5	6.8	7.0	●				
neu	R/L P07M0150-25	1.5		0.1	2.8	6.3	40	25	2.5	6.8	7.0	●				
neu	R/L P07M0150-30	1.5		0.1	2.8	6.3	45	30	2.5	6.8	7.0	●				
neu	R/L P07M0157-10	1.57	0.062"	0.1	2.8	6.3	25	10	2.5	6.8	7.0	●				
neu	R/L P07M0157-25	1.57	0.062"	0.1	2.8	6.3	40	25	2.5	6.8	7.0	●				
	↳ ...															

670...  
676...  
687...  
...7

Weitere HM Sorten können Sie in der Sortenübersicht im Kapitel "Technische Hinweise" und der Preisliste finden.

More carbide grades you can find in the grades summary in the chapter "technical instructions" and in the price list.

Bestellbeispiel:  
für rechte Ausführung und Sorte  
RP07M0100-10/P04C

order-example:  
righthand version and grade  
RP07M0100-10/P04C